



CKC 90

CKC 100

CKC 130

Frigo sopra banco 3 lati vetro ventilato
 Ventilated glass doors countertop display cooler

-
-
-
-
-
-

Mensole
Shelves

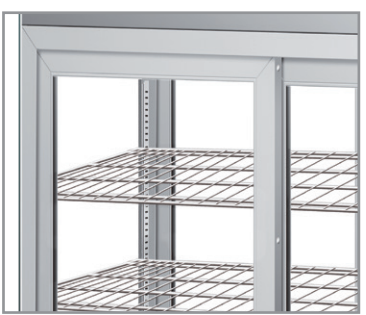

Termostato elettronico
Electronic thermostat



Griglia di ventilazione
Ventilation grid



Caratteristiche / Features

Modello / Model	CKC 90	CKC 100	CKC 130
Temperatura / Temperature Range	+3 °C / +8 °C	+3 °C / +8 °C	+3 °C / +8 °C
Classe Climatica / Climate Class	4	4	4
Volume Netto-Lordo / Net-Gross Volume	Lt. 110 / 120	Lt. 150 / 163	Lt. 190 / 212
Superficie Esterna / Body	Acciaio Inox Stainless Steel	Acciaio Inox Stainless Steel	Acciaio Inox Stainless Steel
Porta / Door	Vetro / Glass	Vetro / Glass	Vetro / Glass
Superficie Interna / Inner Liner	Acciaio Inox Stainless Steel	Acciaio Inox Stainless Steel	Acciaio Inox Stainless Steel
Termostato / Thermostat	Elettronico / Electronic	Elettronico / Electronic	Elettronico / Electronic
Spessore isolamento / Insulation thickness	mm 45	mm 45	mm 45
Sbrinamento / Defrost	A fermo compressore Compressor cycle	A fermo compressore Compressor cycle	A fermo compressore Compressor cycle
Illuminazione / Lighting	1 Led Orizzontale / Horizontal	1 Led Orizzontale / Horizontal	1 Led Orizzontale / Horizontal
Chiusura automatica porta / Self closing door	Si / Yes	Si / Yes	Si / Yes
Mensole (LxP) / Shelves (WxD)	N° 2 - mm 552 x 390	N° 2 - mm 752 x 390	N° 2 - mm 952 x 390
Piedi-Ruote / Feet-Rollers	4 Piedini / 4 Feet	4 Piedini / 4 Feet	4 Piedini / 4 Feet
Peso Netto-Lordo / Net-Gross Weight	Kg 59 / 63	Kg 70 / 74	Kg 72 / 76
Voltaggio / Voltage	V 220	V 220	V 220
Frequenza / Frequency	Hz 50	Hz 50	Hz 50
Refrigerante / Refrigerant	R600A	R600A	R600A
Assorbimento / Absorption	W 180	W 180	W 180
Consumo Energia / Energy Consumption	KwH/24H 3,46	KwH/24H 3,75	KwH/24H 4,08

CKC 90 FRONTE / FRONT

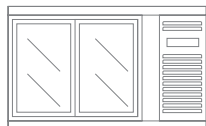

LATO / SIDE



CKC 100 FRONTE / FRONT

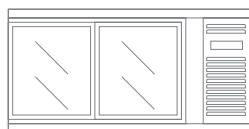

CKC 130 FRONTE / FRONT

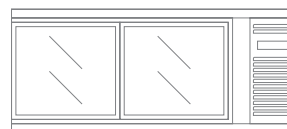
Dimensioni mm / Dimensions mm

Modello / Model	CKC 90	CKC 100	CKC 130
Dimensioni Esterne (LxPxH) / External Dimensions (WxDxH)	910 x 510 x 566	1110 x 510 x 566	1310 x 510 x 566
Dimensioni Imballo (LxPxH) / Packaging Dimensions (WxDxH)	970 x 570 x 640	1170 x 570 x 640	1370 x 570 x 640

Dimensioni Interne mm / Inner Dimensions mm

A - Larghezza / Width	590	790	990
B - Profondità / Depth	400	400	400
C - Altezza / Height	390	390	390